

© Richmond 2022 22130453.000 Tazewell CADD/04-CONTRACT DWGS/011.010-Phase 5B SET/22130453.011_010_03.dwg
 © Schnabel Engineering 2022 All Rights Reserved

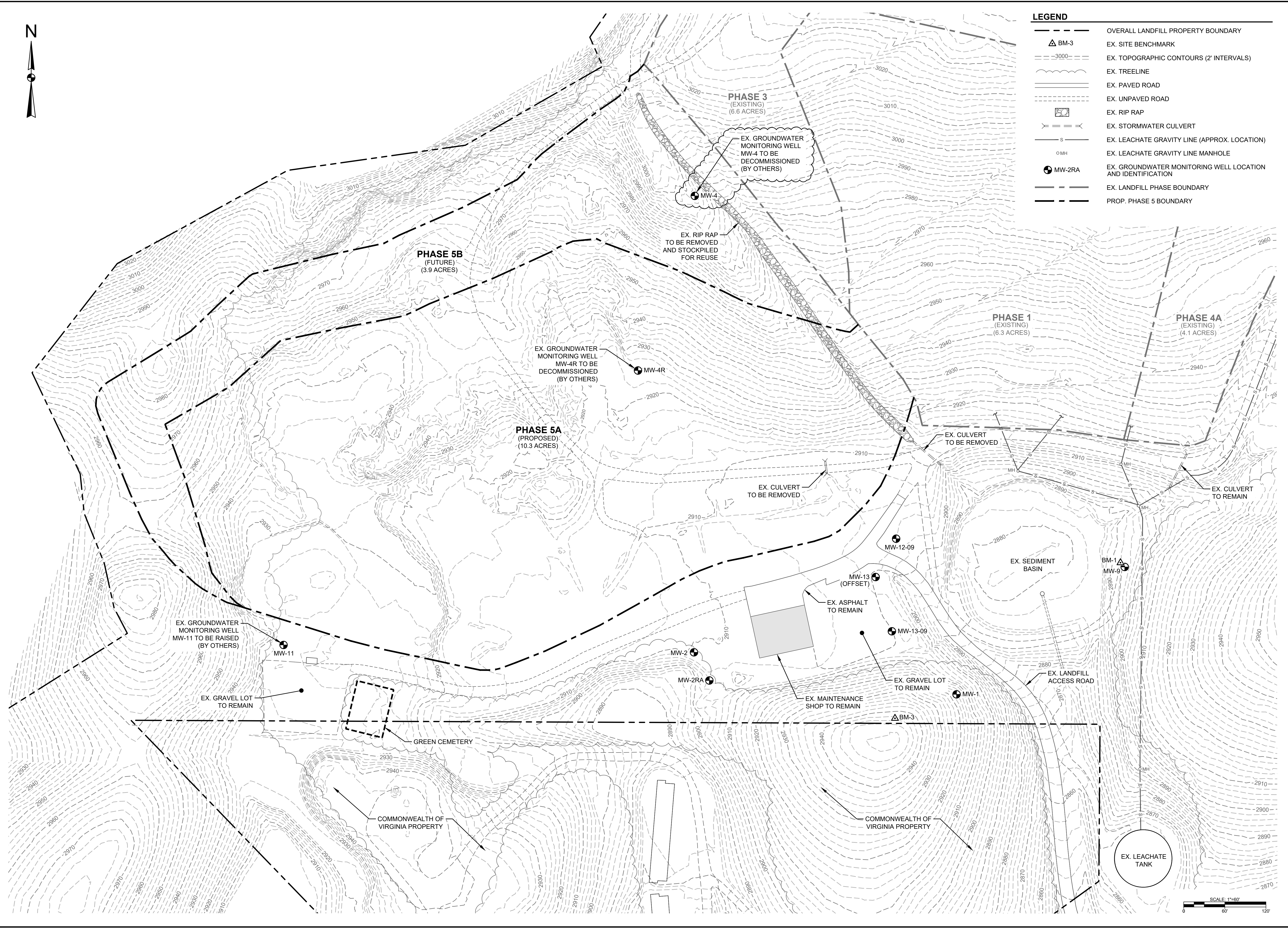

LEGEND	
	OVERALL LANDFILL PROPERTY BOUNDARY
	EX. SITE BENCHMARK
	EX. TOPOGRAPHIC CONTOURS (2' INTERVALS)
	EX. TREELINE
	EX. PAVED ROAD
	EX. UNPAVED ROAD
	EX. RIP RAP
	EX. STORMWATER CULVERT
	EX. LEACHATE GRAVITY LINE (APPROX. LOCATION)
	EX. LEACHATE GRAVITY LINE MANHOLE
	EX. GROUNDWATER MONITORING WELL LOCATION AND IDENTIFICATION
	EX. LANDFILL PHASE BOUNDARY
	PROP. PHASE 5 BOUNDARY

Schnabel ENGINEERING <small>9800 JEB Stuart Parkway, Suite 100 Glen Allen, VA 23059 Phone: 804-649-7035 schnabel-eng.com</small>	EXISTING CONDITIONS									
TAZEWELL COUNTY LANDFILL PHASE 5A CONSTRUCTION DRAWINGS TAZEWELL COUNTY, VIRGINIA	EXISTING CONDITIONS									
PREPARED FOR: SANTEK ENVIRONMENTAL OF VIRGINIA, LLC	PROJECT: 22130453.011 DATE: 02/24/23 DRAWING: 3 SHEET: 3 OF 14									
	<table border="1" style="width: 100%; border-collapse: collapse;"> <thead> <tr> <th>REV.</th> <th>DESCRIPTION</th> <th>DATE</th> </tr> </thead> <tbody> <tr> <td>1</td> <td>UPDATED WELLS. ADDITIONAL WELL TO BE DECOMMISSIONED</td> <td>02/24/23</td> </tr> <tr> <td>0</td> <td>ISSUED FOR BIC (ORIGINAL ISSUE)</td> <td>02/24/23</td> </tr> </tbody> </table>	REV.	DESCRIPTION	DATE	1	UPDATED WELLS. ADDITIONAL WELL TO BE DECOMMISSIONED	02/24/23	0	ISSUED FOR BIC (ORIGINAL ISSUE)	02/24/23
REV.	DESCRIPTION	DATE								
1	UPDATED WELLS. ADDITIONAL WELL TO BE DECOMMISSIONED	02/24/23								
0	ISSUED FOR BIC (ORIGINAL ISSUE)	02/24/23								

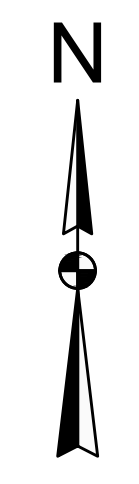